



VDD CONTROL
DUAL TONE

电源控制
128 音符双音 IC

| | |
|--------|--|
| MELODY | |
| M994A | |

FEATURES 功能叙述

- Dual tone 128 notes.
- OL : Switch of one octave lower output.
- Package : TO92-3L.

| P/N | SONG LIST |
|-----------|------------------------|
| M994A-05L | SWEET HOME |
| M994A-19L | FOR ALICE |
| M994A-68L | SMALL WORLD (18 Sec) |
| M994A-69L | SMALL WORLD (14 Sec) |
| M994A-LBL | LOVE BLUE |

APPLICATION 产品应用

- Telephone, EPABX, Toys etc..

ELECTRICAL CHARACTERISTICS 电气规格

(@V_{DD}=3V unless otherwise specified)

| Characteristics | Sym. | Min. | Typ. | Max. | Unit | REMARKS |
|----------------------------|------------------|------|------|------|------|------------------------|
| 工作电压 Operating Voltage | V _{DD} | — | 3 | 3.5 | V | |
| 工作电流 Operating Current | I _{OP} | — | 0.4 | 0.7 | mA | No load |
| 静态电流 Quiescent Current | I _{SB} | — | — | — | μ A | |
| 推动电流 BZ Driving Current | I _O | 0.4 | 0.7 | — | mA | @V _{DS} =1V |
| 推动电流 LED Driving Current | I _{OL} | 6 | 6 | — | mA | @V _{DS} =1.2V |
| 振荡频率 Oscillator Frequency | F _{OSC} | — | 250 | — | KHz | ±30% TOL. |
| 工作温度 Operating Temperature | Temp. | 0 | 25 | 60 | °C | |

APPLICATION DIAGRAM 参考电路图

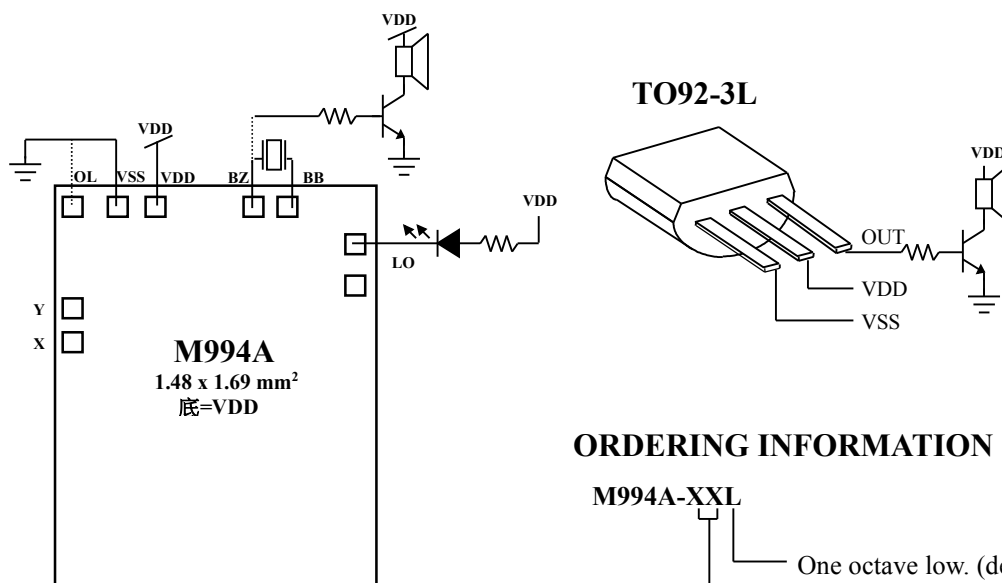

ORDERING INFORMATION

M994A-XXL
 — One octave low. (default Normal)
 — Song Name

*All specs and applications shown above subject to change without prior notice.
(以上电路及规格仅供参考,本公司得径行修正)



VDD CONTROL
DUAL TONE

电源控制
128 音符双音 IC

| | |
|--------|--|
| MELODY | |
| M994A | |

PACKAGE OUTLINE

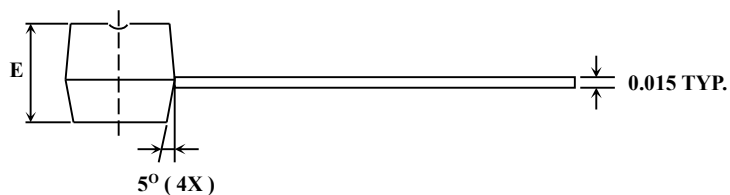
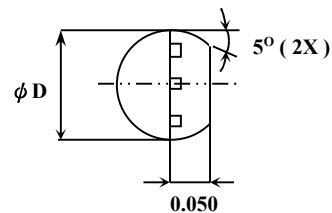
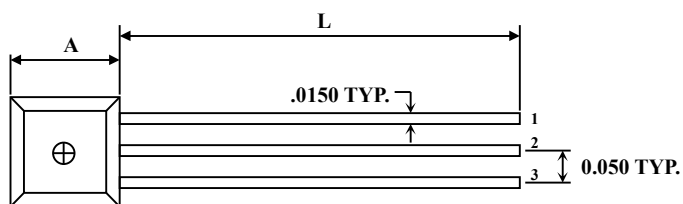

| SYMBOLS | MIN | NOR. | MAX |
|----------|------|------|------|
| A | .170 | .180 | .210 |
| ϕD | .175 | .180 | .205 |
| E | .125 | .142 | .165 |
| L | .500 | .580 | |

UNIT : INCH

TO-92-L3